

PICK AND PLACE CAP

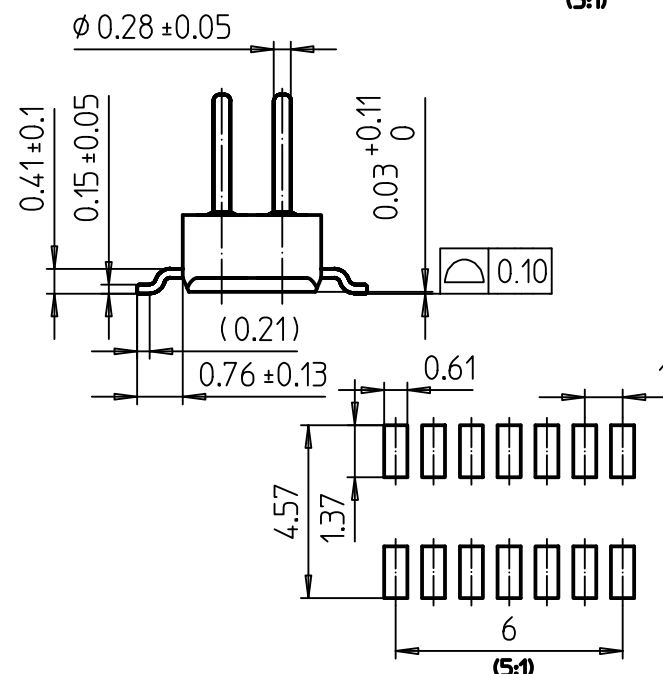
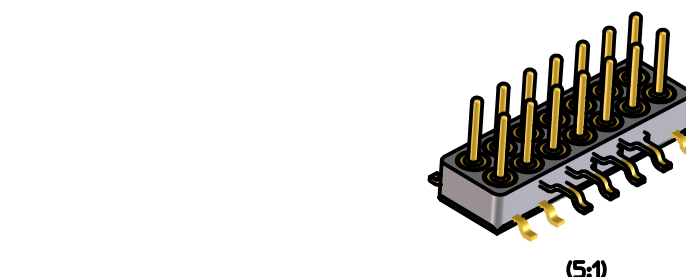
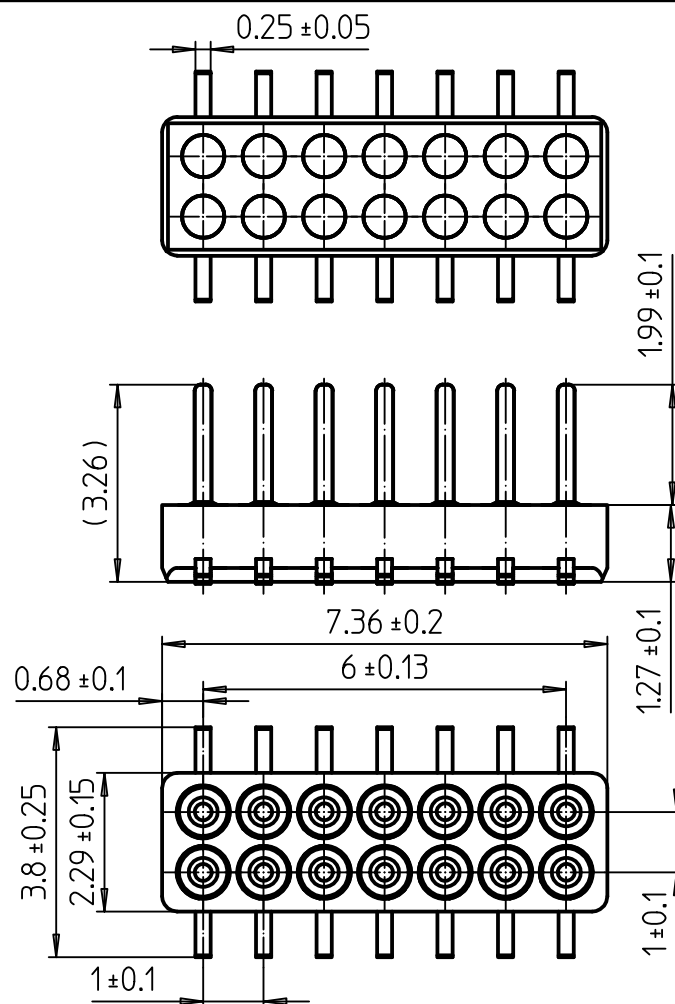
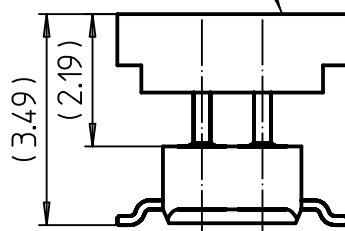

Recommended PCB LAYOUT
Tolerance: +/-0.05

Notes:

1. Main body part material
Insulator: LCP Black UL94V-0
Contact: Copper alloy, 1.27 µm Ni under plated,
contact area plating Au 0.76 µm. Tail plating Gold flash.
Cap: LCP Black UL94V-0
2. Electrical requirements:
Current rating: 1.1A
Contact resistance: ≤ 20 mΩ (initial)
Insulation resistance: ≥ 1000 MΩ
Withstanding voltage: 500 V_{r.m.s.}, 1mA, 60s
3. Mechanical requirements
Insertion force: 3N max./per contact
Extraction force: 0.2N min./per contact
Mechanical life: 100 cycles
4. Environment specification
Working temperature: -40°C ~ +85°C
Humidity: ≤ 93% at 40°C
Resistance to soldering heat: 260°C, 30s
5. Packing & storing
Method of packing: Tape & reel, outer box
Storing condition: temperature of -10°C ~ +40°C
below 80% relative humidity
6. Style of installation: SMT
7. To prevent the pollution of the environment product info
RoHS agreement: In line with the European Union RoHS.

Pos.	Designation	Qty	Material - Finish		
.	.	.	.		
.	.	.	.		
14 way male connector			8:1	Replace: .	
				Replaced by: .	
			8:1	Drawn	26.03.2021
				Checked	
			Drawing nr		Revision
			8MM-SS-0014-02-589191		P2



preci-dip
swiss world connects